

Wysokość 199 mm

# System szuflad Sevrollbox – instrukcja montażu

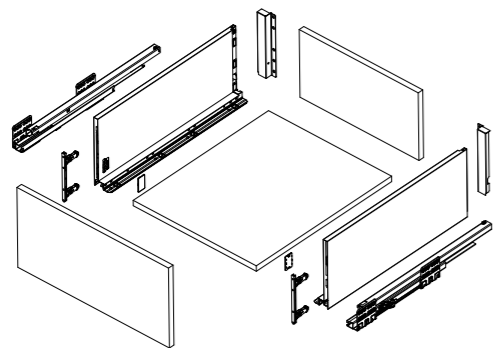

## Elementy zestawu



## Wymiary cięcia płyty 16 mm

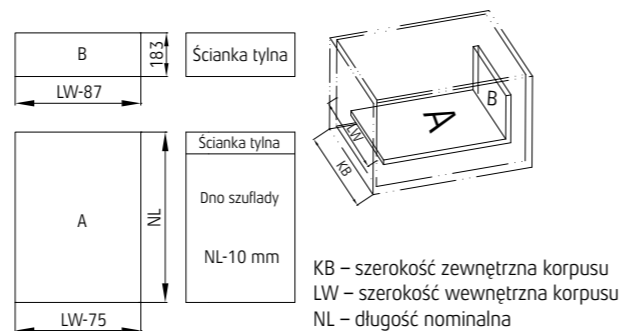

## Montaż szuflady

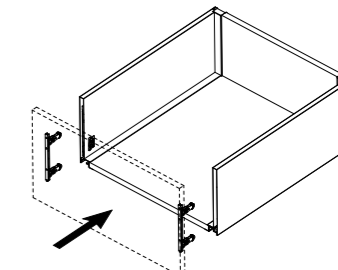
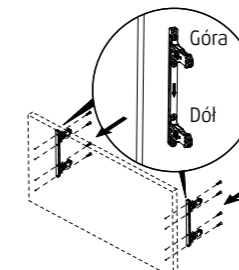
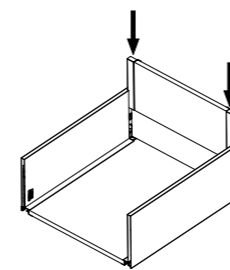

## Wymagana przestrzeń

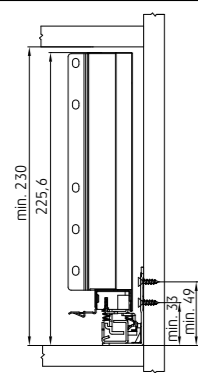

## Wymiary do montażu

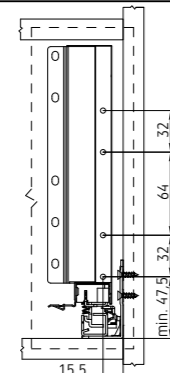

## Wymiary montażowe frontu

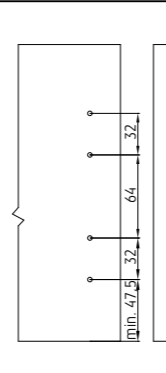

## Wymiary montażowe ścianki tylnej

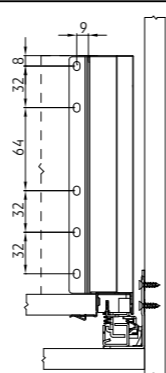

## Regulacja

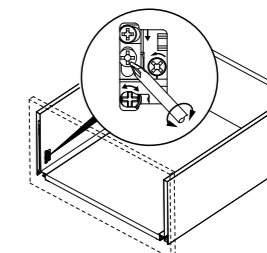
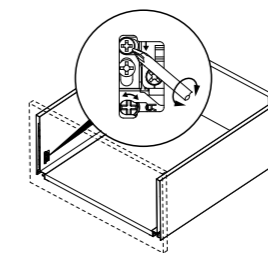
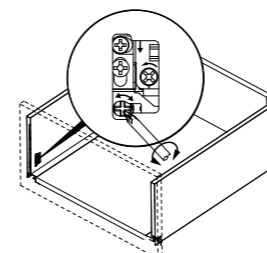

## Demontaż panelu przedniego

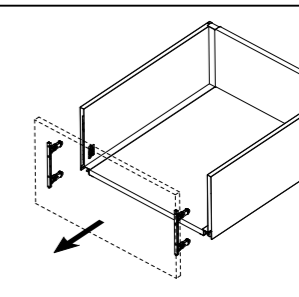
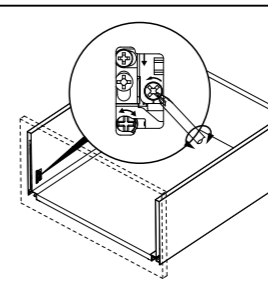
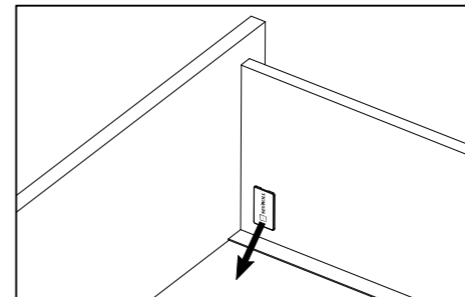

## Mocowanie prowadnicy

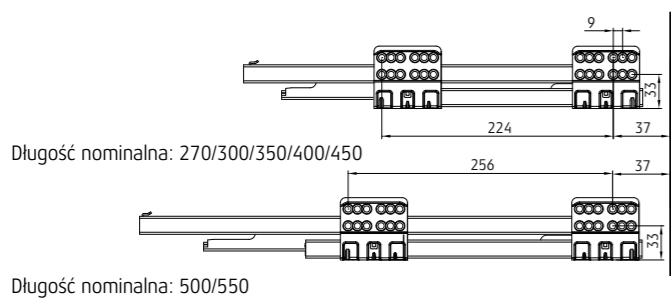

## Mocowanie dystansu

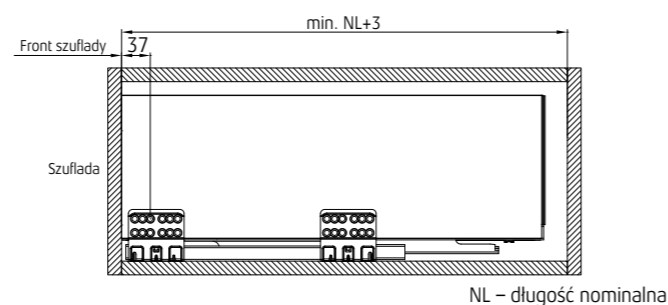

## Montaż szuflady

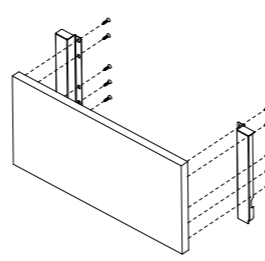
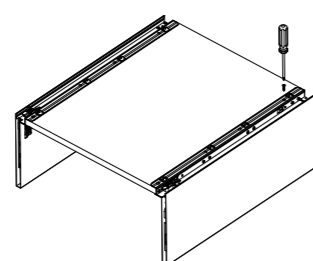
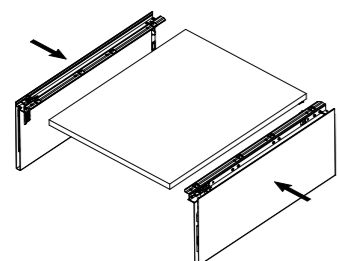

## Wsuniecie szuflady

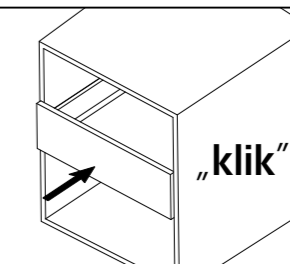
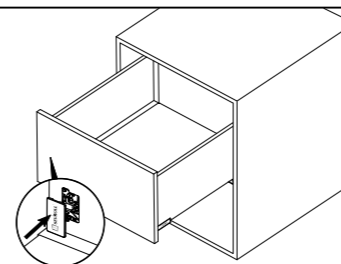

## Wysunięcie szuflady

