

Wysokość 167 mm

System szuflad Sevrollbox – instrukcja montażu

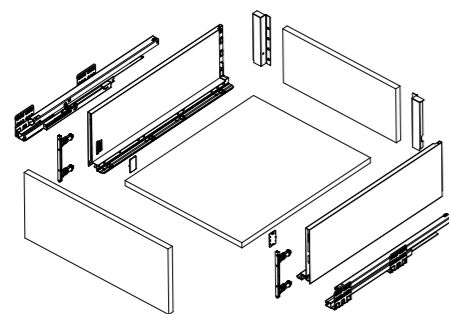

Elementy zestawu



Wymiary cięcia płyty 16 mm

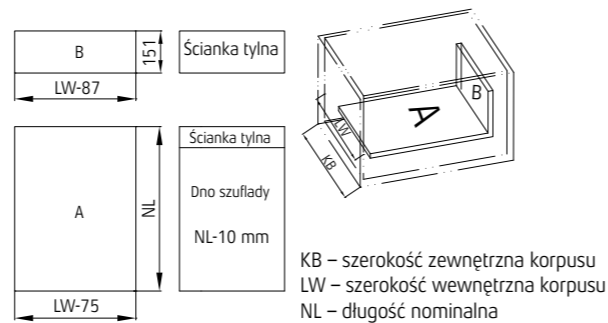

Montaż szuflady

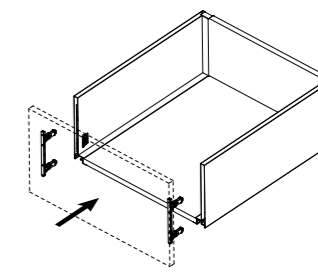
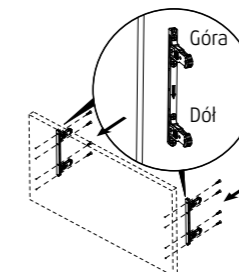
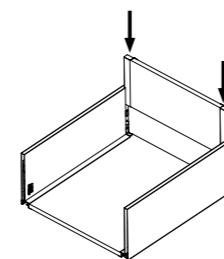

Wymagana przestrzeń

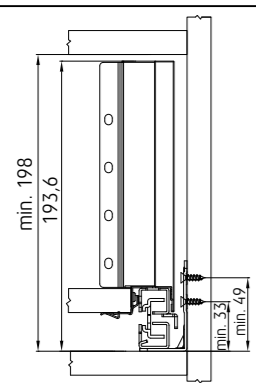

Wymiary do montażu

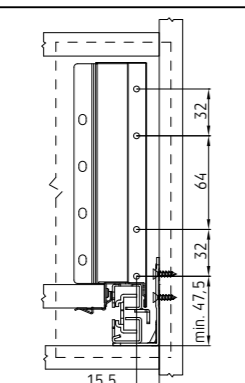

Wymiary montażowe frontu

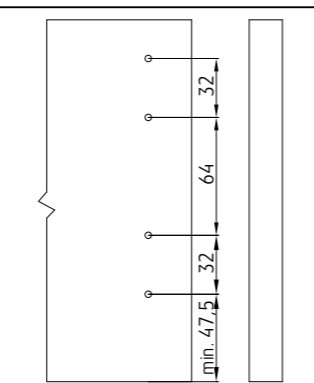

Wymiary montażowe ścianki tylnej

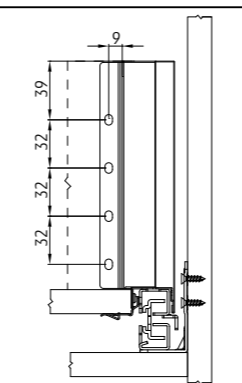

Regulacja

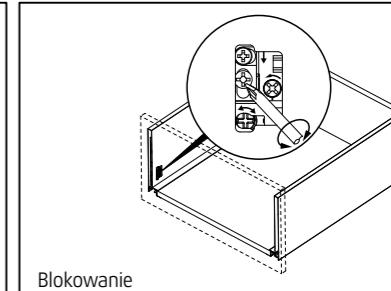
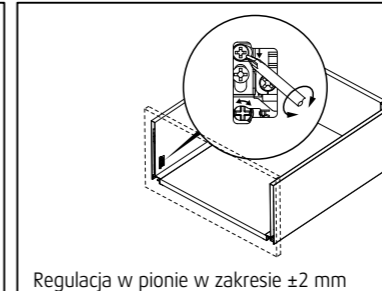
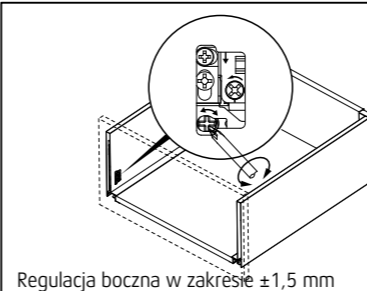

Demontaż panelu przedniego

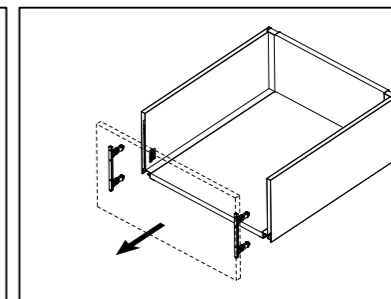
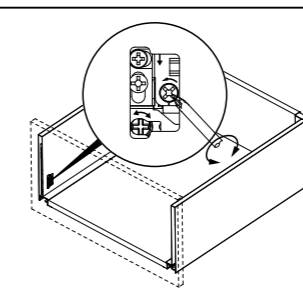
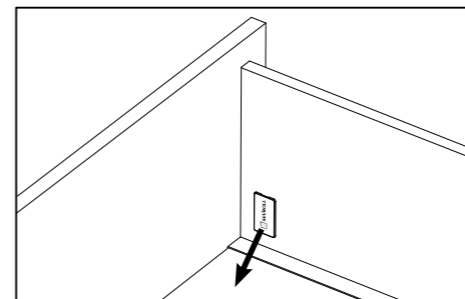

Mocowanie prowadnicy

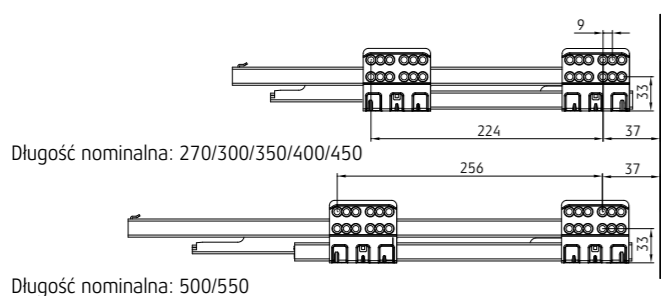

Mocowanie dystansu

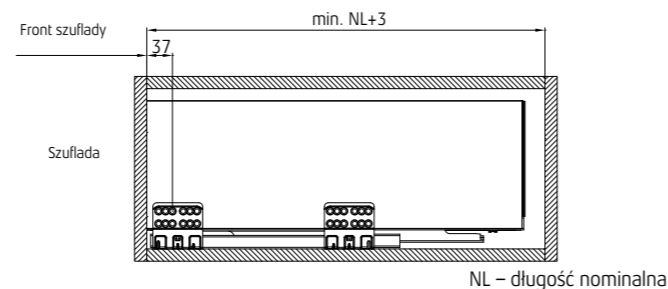

Wsunięcie szuflady

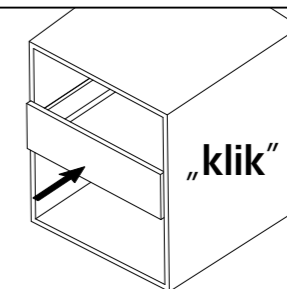
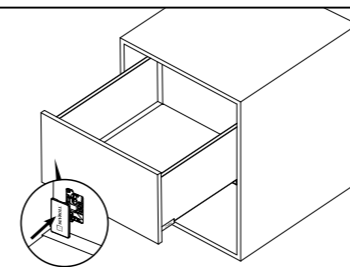

Montaż szuflady

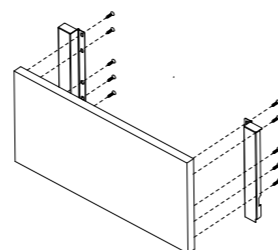
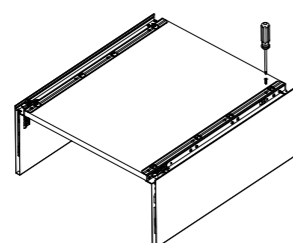
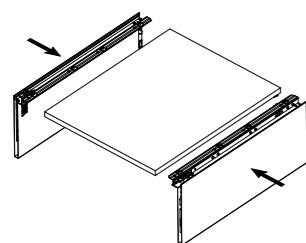

Wysunięcie szuflady

